

DID YOU KNOW?

about our...



Page 1 of 2

**NEW
PRODUCT**

XBolt® Countersunk Head

XBolt® is a single unit screw type anchor that can be used in solid concrete applications. Fixing is achieved by screwing the anchor into a drilled hole in concrete. As it is screwed in, the anchor taps the hole, thus enabling it to produce a mechanical interlock with the concrete.

XBOLT® DRIVE CSK HEAD MECHANICAL GALVANISED / HEC



Part	QFind	Diameter	Internal Hex	Length (mm)	Pack Qty
		Ø (mm)	(mm)		
MXKMSGM060050	MXK100	M6	5	50	100
MXKMSGM060075	MXK101	M6	5	75	50
MXKMSGM080050	MXK102	M8	6	50	50
MXKMSGM080075	MXK103	M8	6	75	50
MXKMSGM080100	MXK104	M8	6	100	50
MXKMSGM100060	MXK105	M10	8	60	50
MXKMSGM100075	MXK106	M10	8	75	50
MXKMSGM100100	MXK107	M10	8	100	50
MXKMSGM120075	MXK108	M12	10	75	50
MXKMSGM120100	MXK109	M12	10	100	50
MXKMSGM120150	MXK110	M12	10	150	50

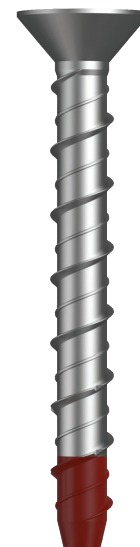

Installation

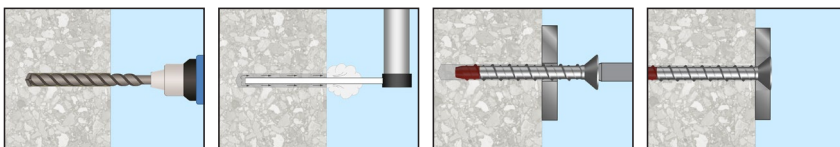

FEATURES

- Rapid simple installation
- Close edge distance install
- Immediate loading of fixture
- Shallow embedment depth
- Fully removable
- Countersunk head for flush finish

XBolt

Disclaimer: While every reasonable effort has been made to ensure that this document is correct at the time of printing, Hobson Engineering®, its agencies and employees, disclaim any and all liability to any person in respect of anything or the consequences of anything done or omitted to be done in reliance upon the whole or any part of this document.

Bolt Tension | Anti-Vibration | Product Reliability | Traceability

hobson.com.au **QUALITY FASTENERS SINCE 1935**



1808131DYK

DID YOU KNOW?

about our...



Page 2 of 2

**NEW
PRODUCT**

XBolt[®] Countersunk Head

XBOLT[®] DRIVE CSK HEAD ZINC YELLOW PASSIVATE / HEC



Part	QFind	Diameter	Internal Hex	Length (mm)	Pack Qty
		Ø (mm)	(mm)		
MXKMSYM060050	MXK111	M6	5	50	100
MXKMSYM060075	MXK112	M6	5	75	50
MXKMSYM080050	MXK113	M8	6	50	50
MXKMSYM080075	MXK114	M8	6	75	50
MXKMSYM080100	MXK115	M8	6	100	50
MXKMSYM100060	MXK116	M10	8	60	50
MXKMSYM100075	MXK117	M10	8	75	50
MXKMSYM100100	MXK118	M10	8	100	50
MXKMSYM120075	MXK119	M12	10	75	50
MXKMSYM120100	MXK120	M12	10	100	50
MXKMSYM120150	MXK121	M12	10	150	50

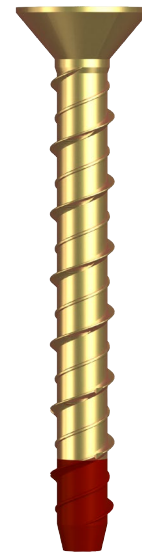

Installation

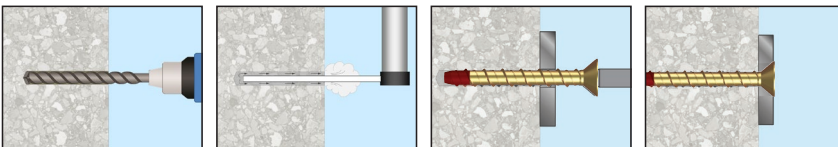

FEATURES

- Rapid simple installation
- Close edge distance install
- Immediate loading of fixture
- Shallow embedment depth
- Fully removable
- Countersunk head for flush finish

XBolt[®]

Disclaimer: While every reasonable effort has been made to ensure that this document is correct at the time of printing, Hobson Engineering®, its agencies and employees, disclaim any and all liability to any person in respect of anything or the consequences of anything done or omitted to be done in reliance upon the whole or any part of this document.

Bolt Tension | Anti-Vibration | Product Reliability | Traceability

hobson.com.au **QUALITY FASTENERS SINCE 1935**



1808131DYK